

DXP4800 Plus 4-Bay Desktop NAS

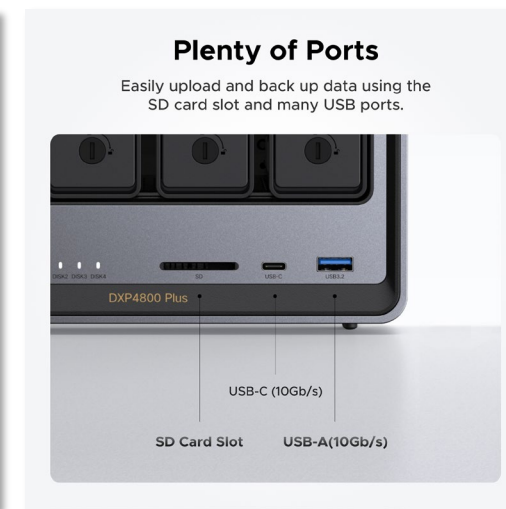

Processor	Intel® Pentium® Gold 8505
RAM	8GB DDR5 64GB Max
Flash Memory	SSD 128GB
RAID	JBOD/Basic/RAID0/1/5/6/10
LAN Ports	2.5GbE*1+10GbE*1
USB 3	1*USB3 Gen2(10Gb/s) 1*TypeC Gen2(10Gb/s) 1*USB3 Gen1(5Gb/s)
USB 2	2*USB2.0 (480Mb/s)

Model - 35261

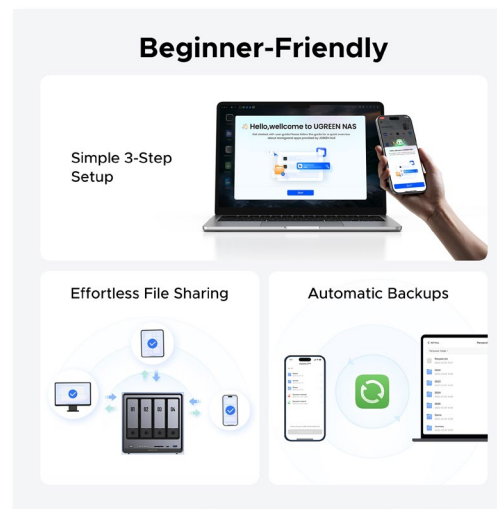
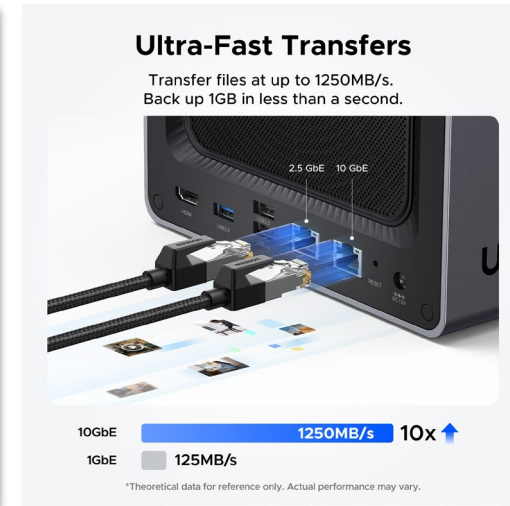

EU DECLARATION OF CONFORMITY

Manufacturer Name: Ugreen Group Limited

Address: Ugreen Building, Longcheng Industrial Park, Longguanxi Road, Longhua, Shenzhen, China

EU Authorized Representative Name: Ugreen Group GmbH

Address: Mannheimer Str. 13, 30880 Laatzen, Germany

We, Ugreen Group Limited, declare under our sole responsibility that the following product:

Product Name: Network Attached Storage

Model Number: DXP4800

Is in conformity with the following EU directives:

Directive 2014/30/EU EMC (Electromagnetic Compatibility)

Test Report number: No. E&A 109335 0066 Rev. 00/6876023083401

Issued by: TÜV SÜD Certification and Testing (China) Co., Ltd. Shenzhen Branch

Address: Building 12 & 13, Zhiheng Wisdomland Business Park, Guankou Erlu, Nantou, Nanshan District, Shenzhen, Guangdong 518052, China

Directive 2014/35/EU LVD (Low Voltage Directive)

Test Report number : No. N5A 109335 0052 Rev. 00/6821023101801

Issued by: TÜV SÜD Certification and Testing (China) Co., Ltd. Shenzhen Branch

Address: Building 12 & 13, Zhiheng Wisdomland Business Park, Guankou Erlu, Nantou, Nanshan District, Shenzhen, Guangdong 518052, China

Directive 2011/65/EU RoHS (Restriction of the use of certain Hazardous Substances)

Test Report number : 68.420.23.1321.01A

Issued by: TÜV SÜD Certification and Testing (China) Co., Ltd. Shenzhen Branch

Address: Building 12 & 13, Zhiheng Wisdomland Business Park, Guankou Erlu, Nantou, Nanshan District, Shenzhen, Guangdong 518052, China

REACH Regulation (EC) No. 1907/2006

Test Report number : No. 68.420.23.1321.01B

Issued by: TÜV SÜD Certification and Testing (China) Co., Ltd. Shenzhen Branch

Address: Building 12 & 13, Zhiheng Wisdomland Business Park, Guankou Erlu, Nantou, Nanshan District, Shenzhen, Guangdong 518052, China

(EU) 617/2013 and Directive 2009/125/EC ErP (Ecodesign requirement for Desktop thin clients, Workstations, Mobile workstations, Small scale servers, Computer servers)

Test Report number : 6818223018701

Issued by: TÜV SÜD Certification and Testing (China) Co., Ltd. Shenzhen Branch

Address: Building 12 & 13, Zhiheng Wisdomland Business Park, Guankou Erlu, Nantou, Nanshan District, Shenzhen, Guangdong 518052, China

POPs (EU) 2019/1021 (persistent organic pollution)

Test Report number : 68.420.23.1321.01D

Issued by: TÜV SÜD Certification and Testing (China) Co., Ltd. Shenzhen Branch

Address: Building 12 & 13, Zhiheng Wisdomland Business Park, Guankou Erlu, Nantou, Nanshan District, Shenzhen, Guangdong 518052, China

Directive 2012/19/EU WEEE (on waste electrical and electronic equipment)

Test Report number : 68.420.23.1321.01G

Issued by: TÜV SÜD Certification and Testing (China) Co., Ltd. Shenzhen Branch

Address: Building 12 & 13, Zhiheng Wisdomland Business Park, Guankou Erlu, Nantou, Nanshan District, Shenzhen, Guangdong 518052, China

Directive 94/62/EC on packaging and packaging waste

Test Report number : 68.420.23.1321.01G

Issued by: TÜV SÜD Certification and Testing (China) Co., Ltd. Shenzhen Branch

Address: Building 12 & 13, Zhiheng Wisdomland Business Park, Guankou Erlu, Nantou, Nanshan District, Shenzhen, Guangdong 518052, China

References to the relevant standards used or references to the specifications in relation to which conformity is declared:

EN 55032:2015/A1:2020

EN IEC 61000-3-2:2019/A1:2021

EN 61000-3-3:2013/A2:2021

EN 55035:2017/A11:2020

EN 62368-1:2014/A11:2017

(EU) 617/2013

IEC 62321

ECHA SVHC

REACH Regulation (EC) No. 1907/2006

Under Article 33 of EU REACH Regulation (1907/2006), Ugreen Group Limited have reviewed our products for the presence of the two hundred and thirty-five (235) SVHC substances on the EU SVHC Candidate List as of Nov.06,2023. No SVHCs were present in product indicated above, in excess of 0.1% by weight except as noted below. According to the specified scope and analytical techniques, the concentration of Lead and Perfluorobutane sulfonic acid (PFBS) and its salts are >0.1% (w/w) in certain component(s), the concentration of each other SVHCs is <0.1% (w/w) in the component(s) of submitted product(s). This determination is based on engineering evaluation, testing, and supplier declarations and is correct to the best of Ugreen Group Limited's knowledge.

Authorized person for technical documentation:

Name: Chi yang

Position: Manager

Date of issue: Dec.20,2023

Signature of authorized Person:



		DXP2800	DXP4800	DXP4800Plus
Overview	Drive Bays	2+2 Bays SATA 2-bay M.2 2-bay	4+2 Bays SATA 4-bay M.2 2-bay	4+2 Bays SATA 4-bay M.2 2-bay
Overview	CPU	Intel N100 4 Cores 4 Threads	Intel N100 4 Cores 4 Threads	Intel 8505 5 Cores 6 Threads
Overview	Memory	8GB DDR5 16GB Maximum Expansion	8GB DDR5 16GB Maximum Expansion	8GB DDR5 64GB Maximum Expansion
Overview	System RAM Spec	-	-	1*GEN3 X4 2242
Overview	System	Pre-installed UGOS Pro 32GB eMMC	Pre-installed UGOS Pro 32GB eMMC	Pre-installed UGOS Pro SSD 128GB
Overview	External Ports	RJ-45 2.5GbE LAN Port	2 x RJ-45 2.5GbE LAN Ports	RJ-45 2.5GbE + 10GbE LAN Ports
Overview	External Ports	USB 3.2 Gen 2 Type-c Gen 2 Maximum Transfer Speed	USB 3.2 Gen 2 Type-c Gen 2 Maximum Transfer Speed	USB 3.2 Gen 2 Type-c Gen 2 Maximum Transfer Speed
Overview	External Ports	-	-	-
Overview	External Ports	-	Self-ejecting SD 3.0 Card Slot	Self-ejecting SD 3.0 Card Slot
Overview	External Ports	4K 60Hz	4K 60Hz	4K 60Hz
CPU	CPU Brand	Intel	Intel	Intel
CPU	CPU Quantity	1	1	1
CPU	CPU Model	N100	N100	8505
CPU	CPU Architecture	X86	X86	X86
CPU	CPU Threads	12th Generation N Series 4 Cores 4 Threads	12th Generation N Series 4 Cores 4 Threads	Pentium Gold 12th Generation 5 Cores 6 Threads
CPU	Photolithography Technology	Intel 7	Intel 7	Intel 7
Memory	Standard Memory	8GB DDR5	8GB DDR5	8GB DDR5
Memory	Memory Expansion	<input checked="" type="checkbox"/>	<input checked="" type="checkbox"/>	<input checked="" type="checkbox"/>
Memory	Maximum Memory Expansion	16GB	16GB	64GB
Hard Drive	SATA Hard Drive Slots	2-bay	4-bay	4-bay
Hard Drive	M.2 NVMe Drive Slots	2-bay	2-bay	2-bay
Hard Drive	M.2 NVMe Slot Spec	GEN3 X2	GEN3 X2	2*GEN4 X4
System	Operating System	UGOS PRO	UGOS PRO	UGOS PRO
System	System Disk	eMMC 32GB	eMMC 32GB	SSD 128GB
Storage	Maximum Storage Capacity	22T*2+4T*2	22T*4+4T*2	22T*4+4T*2
Storage	M.2 Drive Slots	2	2	2

Storage	Storage Mode	JBOD/Basic/RAID0/RAID1	JBOD/Basic/RAID0/RAID1/RAID5/RAID6/RAID10	JBOD/Basic/RAID0/RAID1/RAID5/RAID6/RAID10
Connectivity	RJ-45 2.5GbE LAN Port	1	2	1
Connectivity	RJ-45 10GbE LAN Port	–	–	1
Connectivity	USB 3.2 Gen 1 Port	1	1	1
Connectivity	USB 3.2 Gen 2 Port	1	1	1
Connectivity	Type-c Gen 2 Port	1	1	1
Connectivity	USB 2.0 Port	USB 2.0*2	USB 2.0*2	USB 2.0*2
Connectivity	TBT4	–	–	–
Connectivity	SD Slot	–	SD 3.0	SD 3.0
Connectivity	HDMI	4K	4K	4K
Connectivity	Power	DC 12V/5A	DC 12V/10A	DC 12V/10A
Appearance	Appearance	Upright	Upright	Upright
Appearance	Size (Height x Width x Depth)	L231*W109*H177mm	L257.5*W178*H178mm	L257.5*W178*H178mm
Appearance	Weight – Bare Machine	2.545kg	6.023KG	6.023KG
Appearance	Buttons	Power, Reset	Power, Reset	Power, Reset